

SCHEDULE "A"

CITY OF NANAIMO PRELIMINARY LAYOUT ACCEPTANCE

2023-MAY-26
Date

Approved By
[Signature]

2024-MAY-26
Expiry Date

Parkey Multi-Use Path Connect
& STM - Right-of-Way
Design and Alignment to be determined through DSA

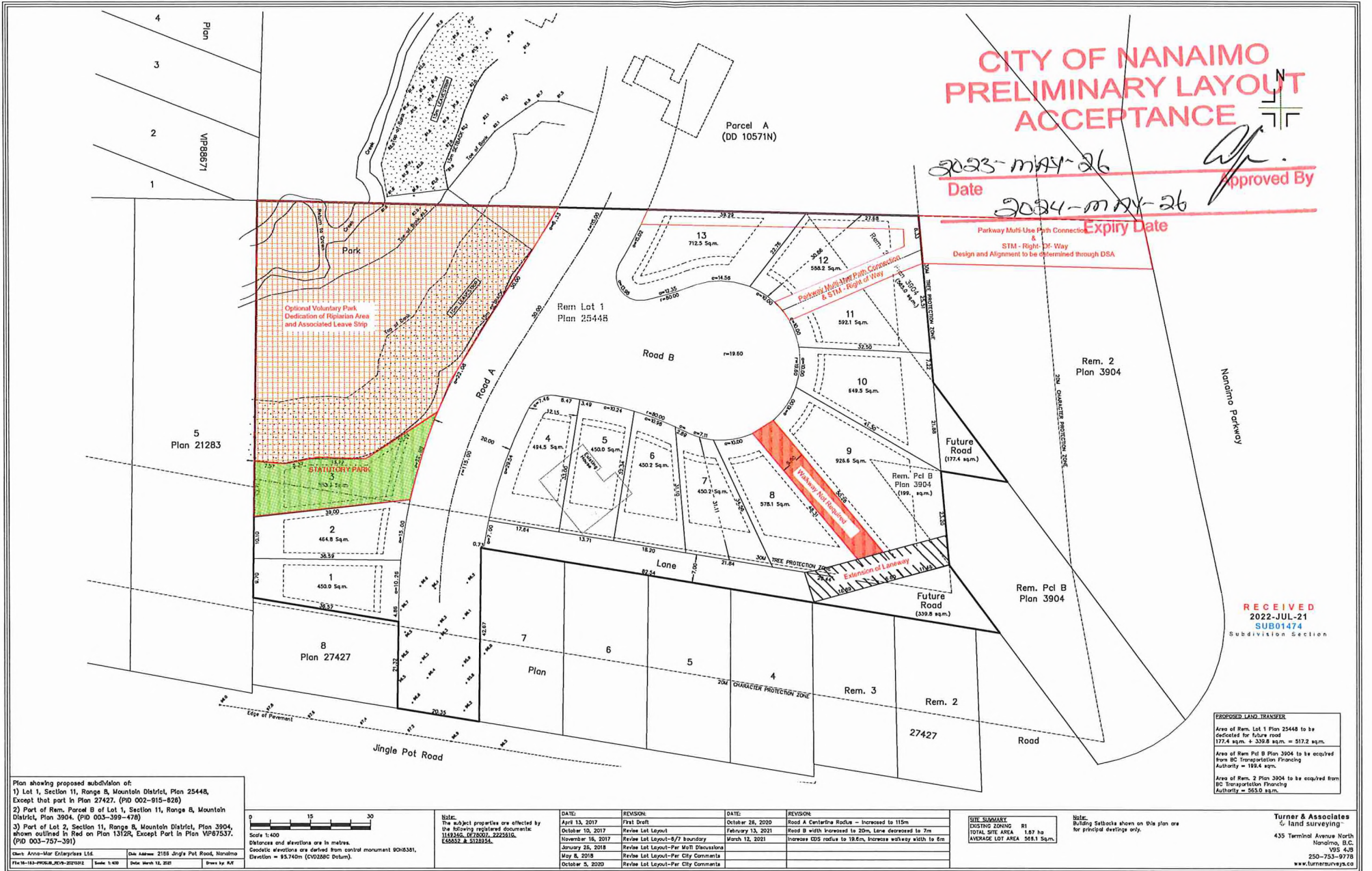

RECEIVED
2022-JUL-21
SUB01474
Subdivision Section

PROPOSED LAND TRANSFER
Area of Rem. Lot 1 Plan 25448 to be dedicated for future road 177.4 sqm + 339.8 sqm = 517.2 sqm.
Area of Rem. Pcl B Plan 3904 to be acquired from BC Transportation Financing Authority = 185.4 sqm.
Area of Rem. 2 Plan 3904 to be acquired from BC Transportation Financing Authority = 563.0 sqm.

Plan showing proposed subdivision of:
1) Lot 1, Section 11, Range 8, Mountain District, Plan 25448, Except that part in Plan 27427. (PID 002-915-828)
2) Part of Rem. Parcel B of Lot 1, Section 11, Range 8, Mountain District, Plan 3904. (PID 003-399-478)
3) Part of Lot 2, Section 11, Range 8, Mountain District, Plan 3904, shown outlined in red on Plan 13129, Except Part in Plan VP87537. (PID 003-757-391)

Client: Anno-Mar Enterprises Ltd. Site Address: 2188 Jingle Pot Road, Nanaimo
File #: 18-183-PROJ-REV-202101 Scale: 1:400 Date: March 12, 2021 Drawn by: AJF

Scale: 1:400
Distances and elevations are in metres.
Geodetic elevations are derived from control monument 90H6381, Elevation = 85.740m (CVD289C Datum).

Note:
The subject properties are affected by the following registered documents:
118116, 8278031, 2222910,
E56552 & S128254.

DATE	REVISION	DATE	REVISION
April 13, 2017	Final Draft	October 26, 2020	Road A Centreline Radius - increased to 115m
October 10, 2017	Review Lot Layout	February 13, 2021	Road B width increased to 20m, Lane depressed to 7m
November 16, 2017	Review Lot Layout-9/7 boundary	March 12, 2021	Increase CD3 radius to 18.6m, increase walkway width to 8m
January 26, 2018	Review Lot Layout-Per Mott Discussions		
May 8, 2018	Review Lot Layout-Per City Comments		
October 5, 2020	Review Lot Layout-Per City Comments		

SITE SUMMARY
DISTRICT ZONING: R1
TOTAL SITE AREA: 1.87 ha
AVERAGE LOT AREA: 268.1 Sqm.

Note:
Building Setbacks shown on this plan are for principal dwellings only.

Turner & Associates
Geomatics & Land Surveying
435 Terminal Avenue North
Nanaimo, B.C.
V9S 4J9
250-753-9718
www.turnersurvey.com